



# VIRTUAL IDEATION QUESTIONNAIRE SUMMARY

*DEC 26, 2023 - JAN 22, 2024*

## Survey Snapshot

|       |        |             |                 |                  |
|-------|--------|-------------|-----------------|------------------|
| Views | Starts | Submissions | Completion rate | Time to complete |
| 1,788 | 1,326  | 761         | 57.4%           | 14:15            |

### Trends

Submissions ▾

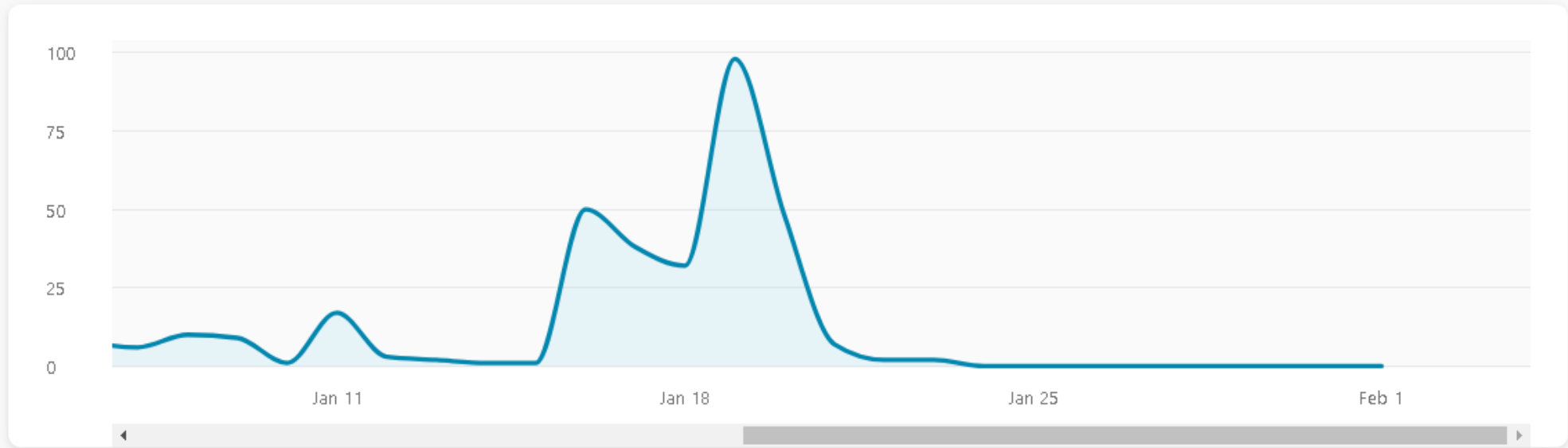

## Question 1

1 → Are you a resident of San Carlos?

*Description (optional)*

Yes

No



## Responses



Are you a resident of San Carlos?

Are you a resident of San Carlos?

761 out of 761 answered

Yes 710 resp. 93.3%



No 51 resp. 6.7%



## Question 2

2 → Which age range do you belong to?

*Description (optional)*

A 17 or younger

B 18-25

C 26-40

D 41-50

E 51-65

F 66-75

G 75+

H Decline to answer

[Add choice](#)

## Responses

Which age range do you belong to?

760 out of 761 answered

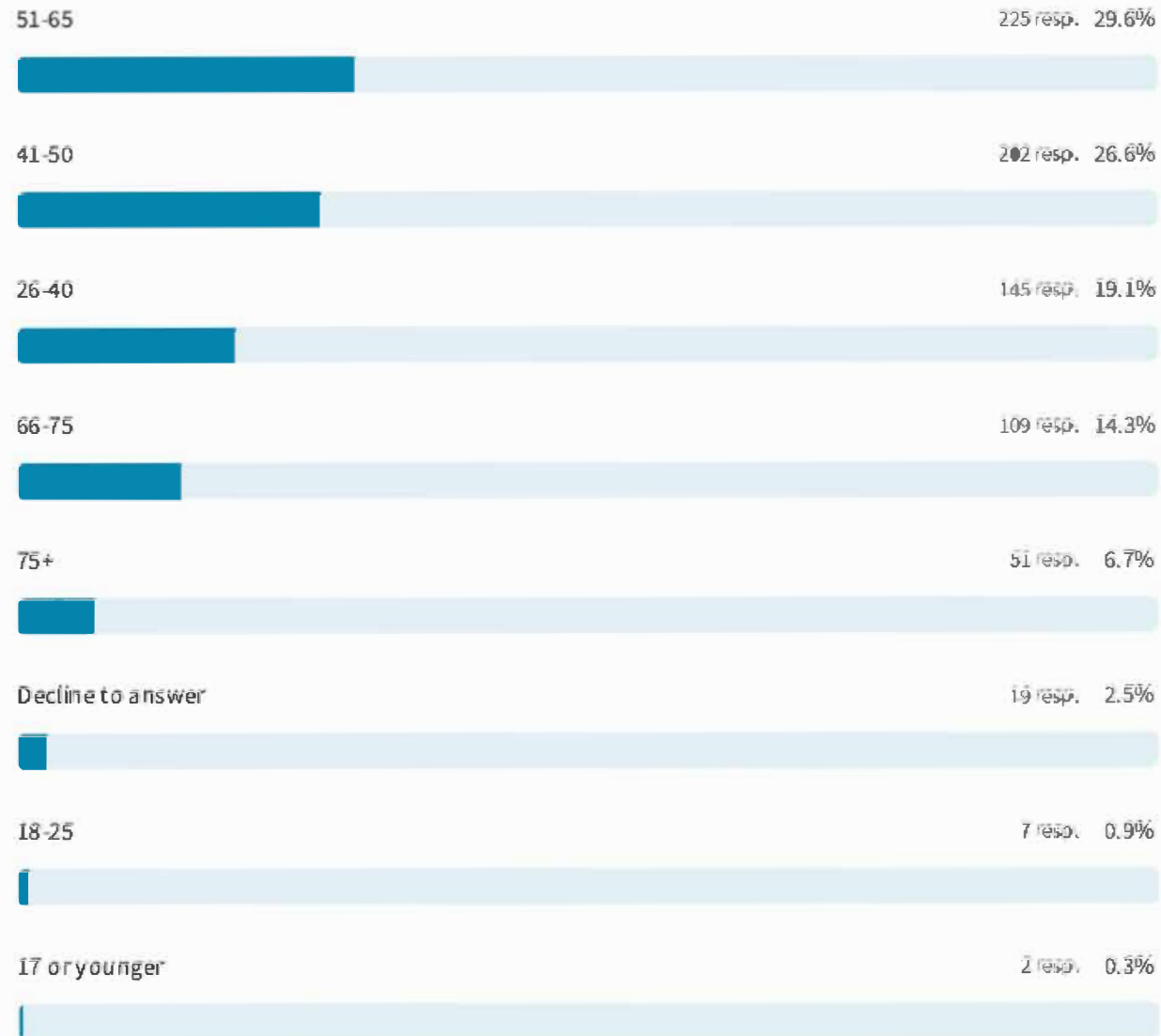

### Question 3

3 → What brings you to downtown San Carlos?

*Description (optional)*

Choose as many as you like

A Live in the area

B Work in the area

C Own a business

D Shopping

E Dining

F Entertainment

G Social meetings

H Festivals and Events

I Passing through

J Other

[Add choice](#)



# Responses

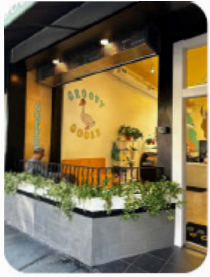

What brings you to downtown San Carlos?

760 out of 761 answered

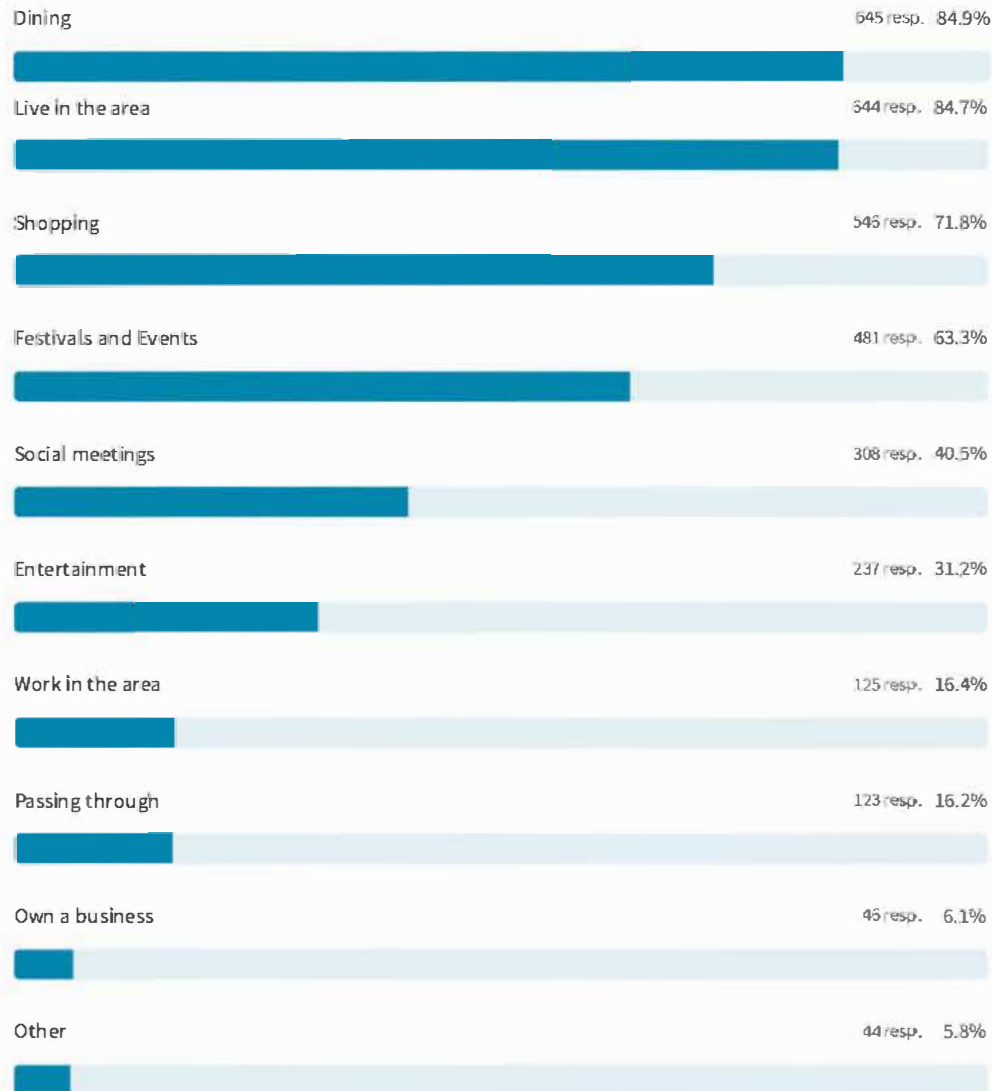



## 'Other' responses:

1. Post office and UPS
2. Banking & post office
3. Meetings at smta
4. Dog walking/exercise
5. Spa nails hair
6. Going for walks
7. Library
8. Childcare
9. Walk
10. Groceries
11. Business, po, grocery, dog walk, etc
12. Post office / ups
13. Walking my dog
14. Post office
15. Biking or walking (exercise)
16. Walking
17. Walking with family
18. Exercise
19. Exercise
20. Picking prescriptions
24. Own property in downtown
25. Post office & ups store
26. Errands (e.G., Post office)
27. Visit businesses
28. Services: ups, usps, hair cut
29. I run run in the neighborhood
30. General interest
31. Support san carlos
32. Taking walks
33. Fitness, farmers market
34. Yoga
35. Boba/cafe
36. Grew up there, mom lives there
37. Used to live in sc
38. Farmer's market
39. Walking dog
40. Exercise
41. Property owner
42. Bank
43. It would be good to have a cafe and community space...

## Question 4

4 → How often do you visit downtown San Carlos?

The downtown area is delineated on the map.

- A Everyday
- B Few times a week
- C Once a week
- D Once a month
- E Occasionally
- F Never

[Add choice](#)



## Respon



How often do you visit downtown San Carlos?

756 out of 761 answered

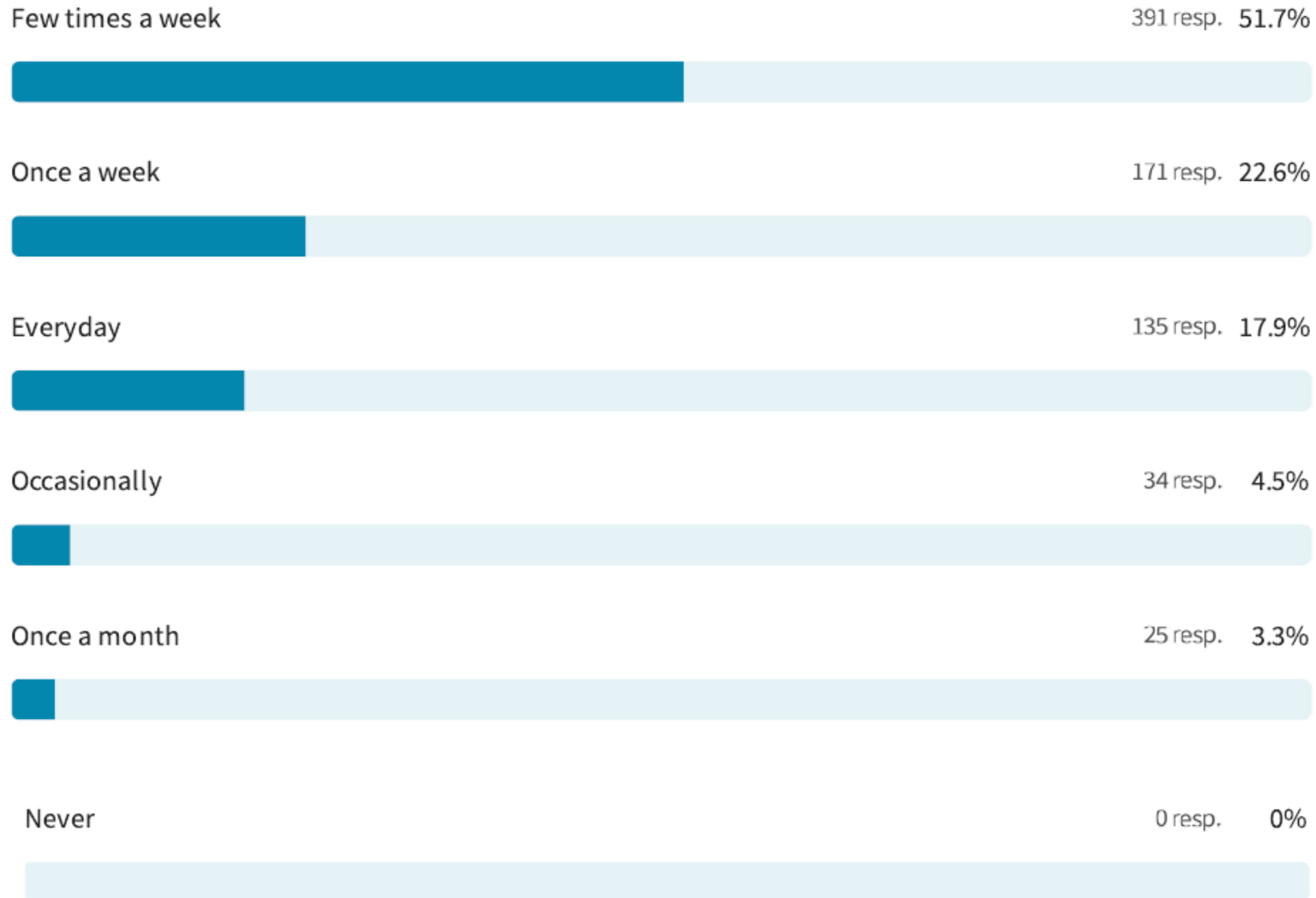

## Question 5

5 → How do you get to the downtown area?

*Description (optional)*

Choose as many as you like

A Walk

B Bike

C Drive

D Transit

E Other

[Add choice](#)



## Responses



How do you get to the downtown area?

761 out of 761 answered

Drive 629 resp. 82.7%



Walk 496 resp. 65.2%



Bike 143 resp. 18.8%



Transit 16 resp. 2.1%



Other 8 resp. 1.1%



### 'Other' responses:

1. Drive if I go to PO or grocery store, or when I have to carry things
2. Scooter
3. Scooter
4. walk/drive
5. Scooter
6. Scooter
7. Mobility scooter

“

## VISION STATEMENT

Downtown is the heart of San Carlos that provides a vibrant, pedestrian-friendly, safe, charming, futuristic, and accessible destination for the community.

It is a place for celebration and gathering that offers diverse and authentic experiences through a draw of food, retail, services, art and music in a visually attractive environment for the growing community. Downtown is an inclusive place with easy access for all, opportunities for housing and businesses of all types, and inviting spaces for all users. Downtown San Carlos is a sustainable district, with landscape that supports ecological and community health & well-being.

The Vision Statement above developed by the community and Downtown Advisory Committee guides the concepts presented in the following slides.

**Continue**

press **Enter** ↵

## Question 6

6 → What would you like downtown San Carlos to be:

*Description (optional)*

A Local destination

B Regional destination

C Both

D Other

[Add choice](#)



## Responses



What would you like downtown San Carlos to be:

760 out of 761 answered

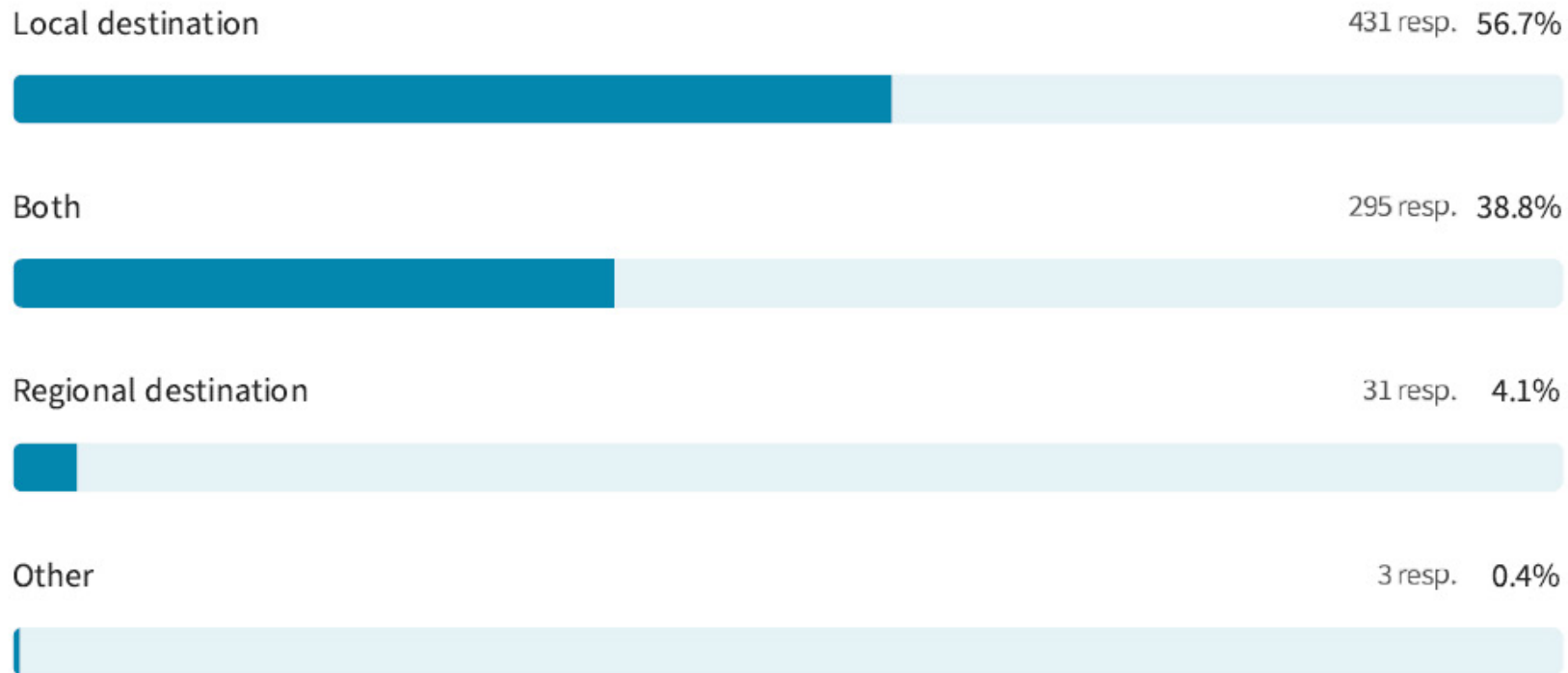

### 'Other' responses:

1. Neither.
2. A place for commerce
3. Keep as small town feel for locals



## Question 7

7 → Public Realm Design: Laurel Street 700 Block.

### Concept 1: The Promenade

Which program or design ideas included here would you like to see on the 700 block of Laurel?

Choose as many as you like

|                                 |                              |  |
|---------------------------------|------------------------------|--|
| <b>A</b> Shade & Seating        | <b>B</b> Pedestrian Paths    | <b>C</b> Community Events                |
| <b>D</b> Public Art Opportunity | <b>E</b> Interactive Element | <b>F</b> Programs for Children and Youth |
| <b>G</b> Concert                | <b>H</b> Play                | <b>I</b> Dogs                            |
| <b>J</b> Outdoor Dining         | <b>K</b> Restrooms           | <b>L</b> Linear Fountain                 |
| <b>M</b> Bioswale               | <b>N</b> Storage and Loading | <b>O</b> Bike                            |
| <b>P</b> Fire Access            | <b>Q</b> Movable Bollards    | <b>R</b> Other                           |

[Add choice](#)

## PUBLIC REALM DESIGN: 700 BLOCK

### CONCEPT 1 - "THE PROMENADE"

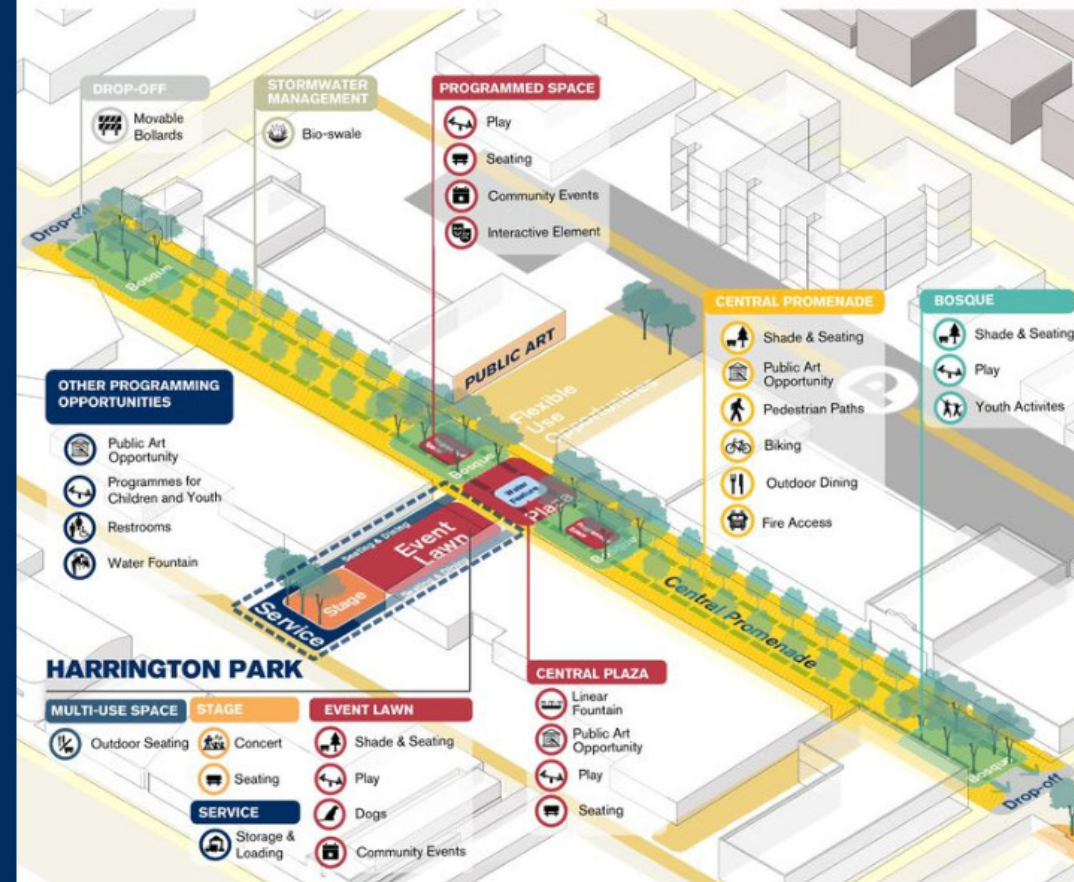

# Responses



## Public Realm Design: Laurel Street 700 Block. Concept 1: The Promenade

749 out of 761 answered

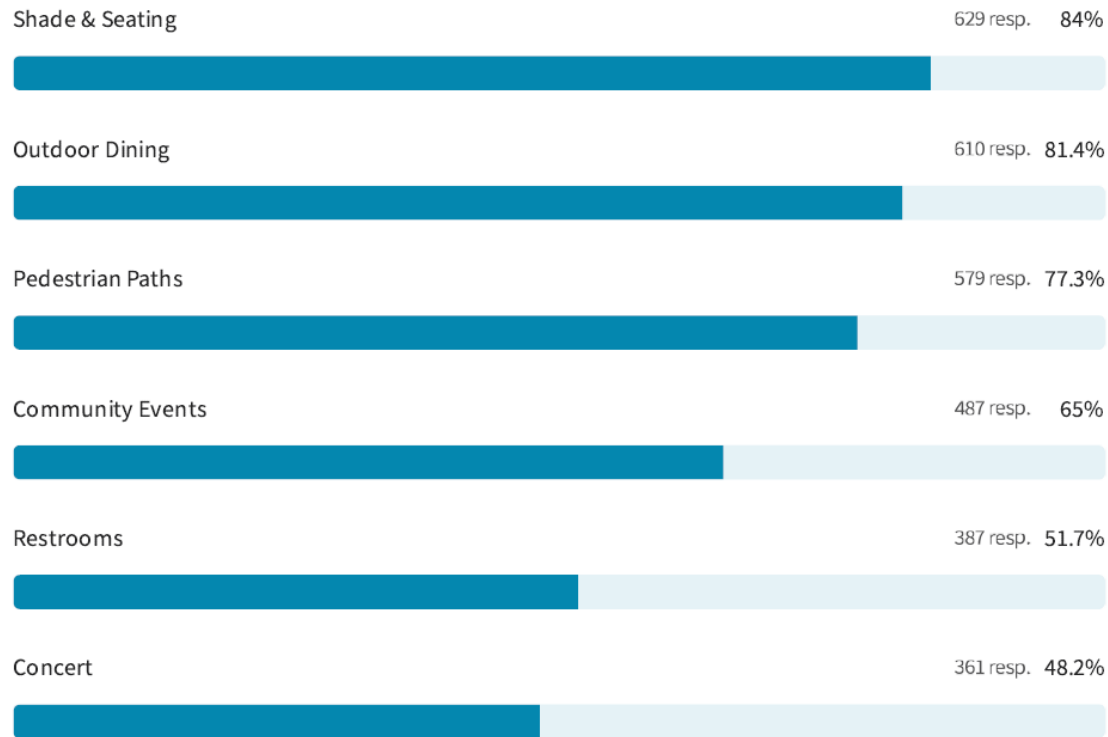

(contd.)

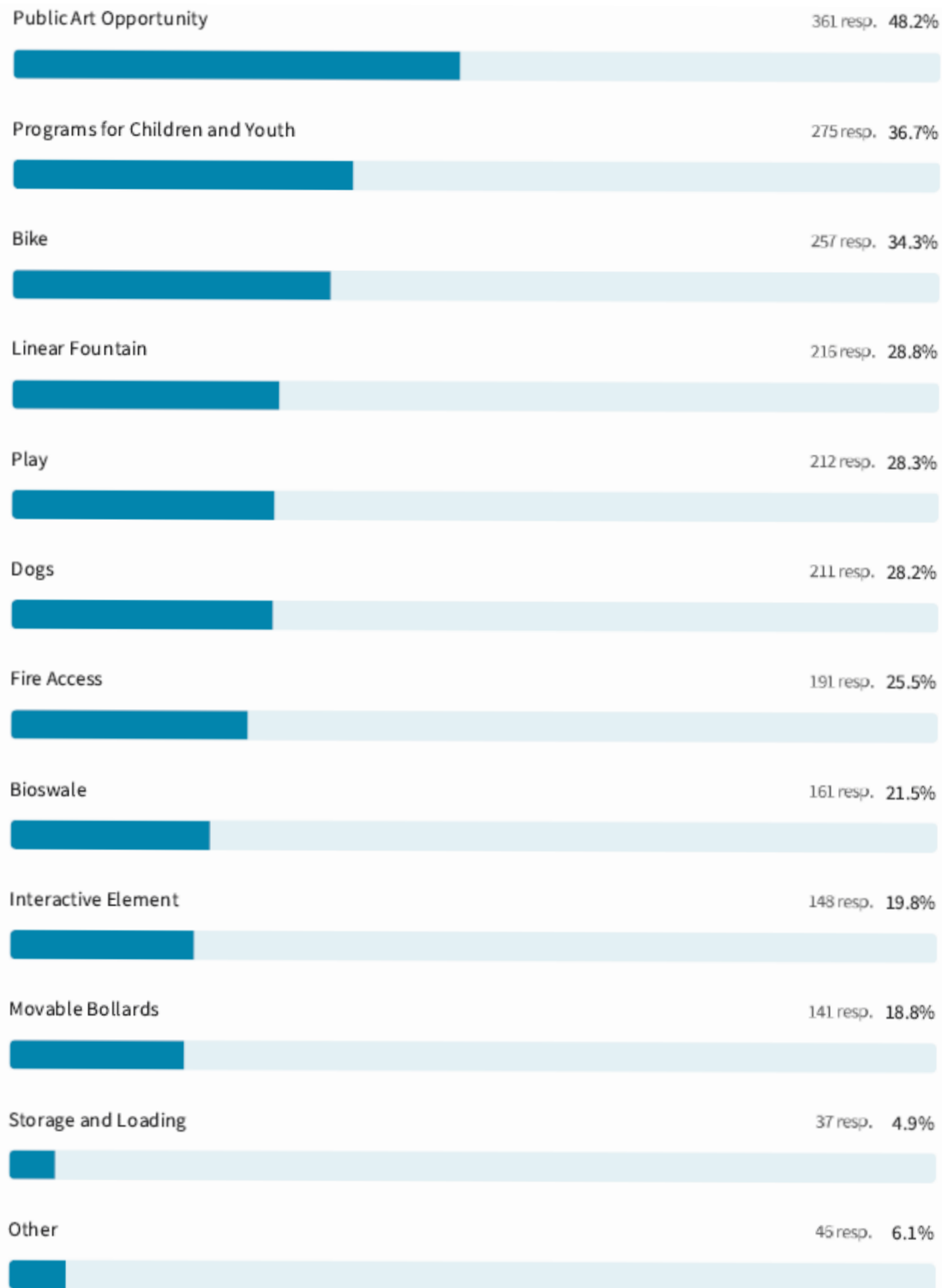

## **'Other' responses:**

1. Improved Parking
2. Leave the alley as-is for business services like trash, etc.
3. Public bathroom in Harrington Park
4. Address traffic issues in the alley
5. More trees
6. Revert to original downtown with street parking
7. Night club
8. Shelter and recreational space for reservations
9. No ugly orange barricades
10. Farmers market
11. Ban wheeled transportation (bicycles, scooters, skateboards)
12. Keep it as an open street
13. Opposition to street closing
14. Restore Laurel Street with parking pre-COVID
15. Not a hangout for teenagers, they have a youth center
16. Implement a great zero waste collection system
17. Provide WIFI
18. More flexible housing along the avenue
19. Reopen the street for cars and parking
20. Live music at night
21. Water fountain with bottle refill and dog water feature
22. More shopping options
23. Accessible parking options behind or on side streets
24. Incorporate nature
25. Single lane road for through traffic
26. Avoid gentrification
27. Pleasant walking environment
28. Level surface from storefront to storefront; no curbs Parking

## Question 8

### 8 → Public Realm Design: Laurel Street 700 Block. Concept 2: The Gardens

Which program or design ideas included here would you like to see on the 700 block of Laurel?

Choose as many as you like

|                                 |                              |  |
|---------------------------------|------------------------------|--|
| <b>A</b> Shade & Seating        | <b>B</b> Pedestrian Paths    | <b>C</b> Community Events                |
| <b>D</b> Public Art Opportunity | <b>E</b> Interactive Element | <b>F</b> Programs for Children and Youth |
| <b>G</b> Play                   | <b>H</b> Dogs                | <b>I</b> Outdoor Dining                  |
| <b>J</b> Restrooms              | <b>K</b> Water Fountain      | <b>L</b> Linear Fountain                 |
| <b>M</b> Rain Garden            | <b>N</b> Storage and Loading | <b>O</b> Bike                            |
| <b>P</b> Fire Access            | <b>Q</b> Movable Bollards    | <b>R</b> Other                           |

Add choice

## PUBLIC REALM DESIGN: 700 BLOCK CONCEPT 2 - "THE GARDENS"

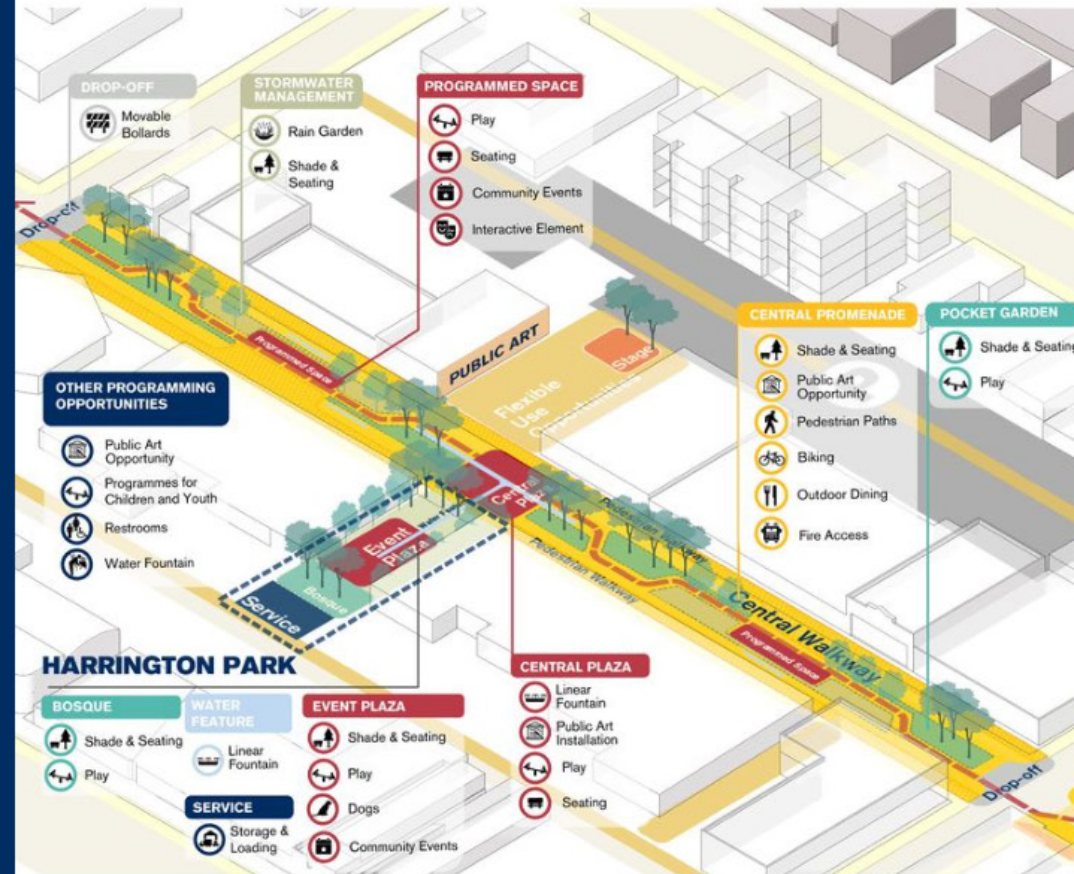

# Responses



## Public Realm Design: Laurel Street 700 Block. Concept 2: The Gardens

738 out of 761 answered

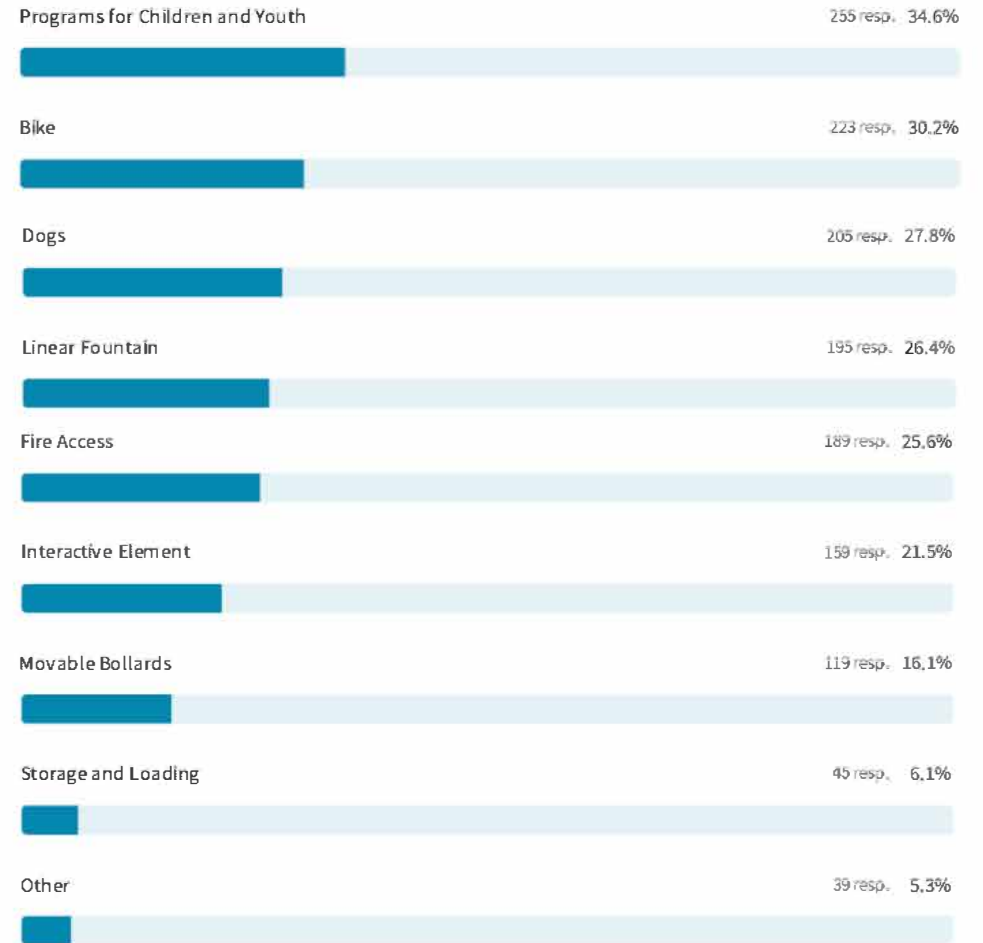
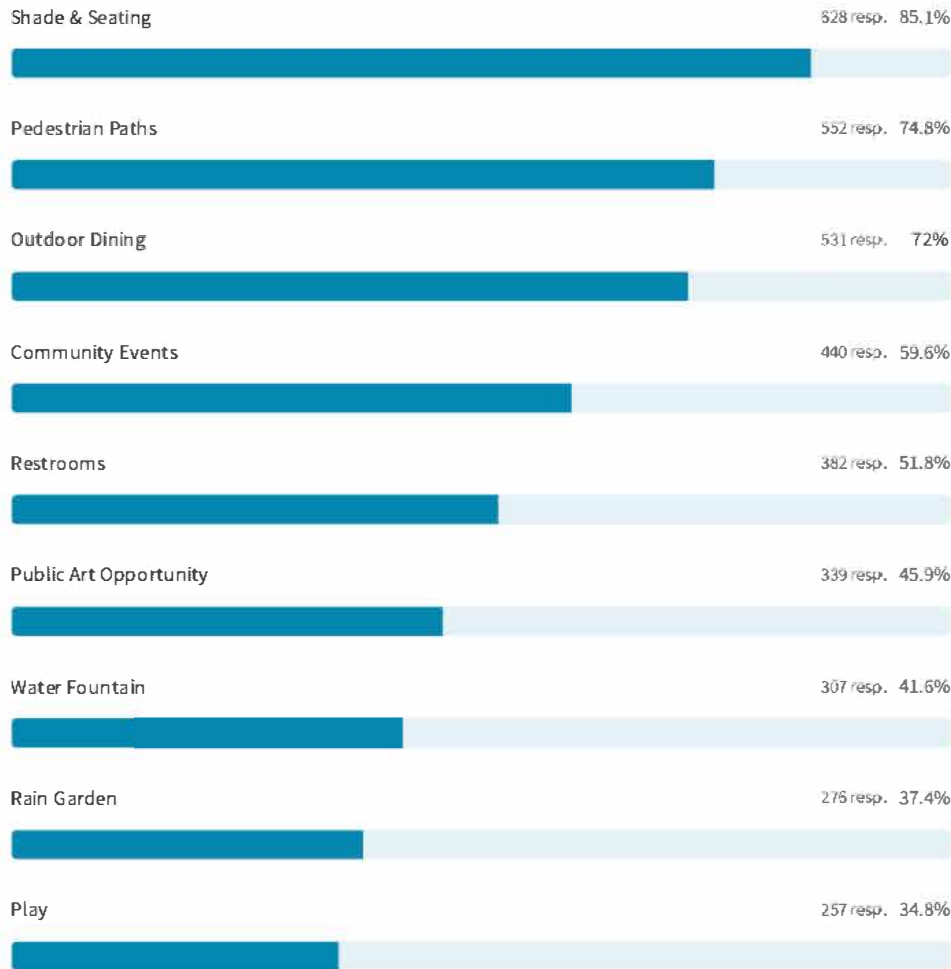

## 'Other' responses:

1. Parking and service. Why is an alley, a rare commodity in the Bay Area, being used like this? Widen the sidewalks on Laurel St, remove some parking there, activate the front of businesses and major corridors.
2. I will add, what was the original plan for the stage at Harrington Park? Has that space been utilized fully to its original concept? Originally (before COVID) Town had a bump-out. It worked. Go back to that plan. Hallmark store has no convenient shopping because people want to eat outside. People with mobility issues are being overlooked. Parking is limited and inconvenient for handicap placard users. A friend using walker can't get to beer place next to Town. Handicap drop off isn't as easy as people think.
3. More trees
4. Night club
5. Covered shelter space for residents to reserve for private parties, family friendly.
6. No Ugly Orange Barricades
7. I do not support the closing of streets
8. Don't change it
9. Go back to laurel street pre-Covid
10. Open Street
11. Gathering space
12. Zero Waste collection bins
13. WIFI
14. Parking (need to be age friendly - we have a large older adult population) also fruit trees
15. Parking for older adults
16. Reopen the street. This block has the most parking spots in town including Handicapped spaces
17. Access for people with disabilities; improved and upgraded pavement/hardscape; increased and clear signage; possibly more security measures due to less activity after business hours; consider shuttles from locations such as senior center, train station for less mobile residents who can't park adjacent to downtown; potential increased parking in underutilized infill areas such as Caltrain right of way, etc
18. More Adult bars/entertainment
19. Playground space
20. Water fountain that features water bottle fill station and dog water fountain
21. SHOPPING! RETAIL! (Hello?!)
22. Quiet zone.
23. Who will take care of linear fountain that will look stupid when it is shut down. And will cost \$\$ to take out.
24. Nature, housing/apartments on top of stores.
25. I cannot walk far so avoid the 700 block
26. A single lane through road for cars
27. No Gentrification
28. Trees and greenery
29. Clean and enjoyable to eat or shop or walk

## Question 9

### 9 → Public Realm Design: Laurel Street 600 Block

Which program or design ideas included here would you like to see on the 600 block of Laurel?

Choose as many as you like

|                                 |  |   |
|---------------------------------|--|---|
| <b>A</b> Shade & Seating        | <b>B</b> Pedestrian Paths                | <b>C</b> Community Events               |
| <b>D</b> Public Art Opportunity | <b>E</b> Programs for Children and Youth | <b>F</b> Outdoor Dining/<br>Food Pop-up |
| <b>G</b> Play                   | <b>H</b> Concert                         | <b>I</b> Dogs                           |
| <b>J</b> Restrooms              | <b>K</b> Water Fountain                  | <b>L</b> Bioswale                       |
| <b>M</b> Storage and Loading    | <b>N</b> Bike                            | <b>O</b> Other                          |

[Add choice](#)

## PUBLIC REALM DESIGN: 600 BLOCK CONCEPT - WHEELER PLAZA







## Public Realm Design: Laurel Street 600 Block

724 out of 761 answered

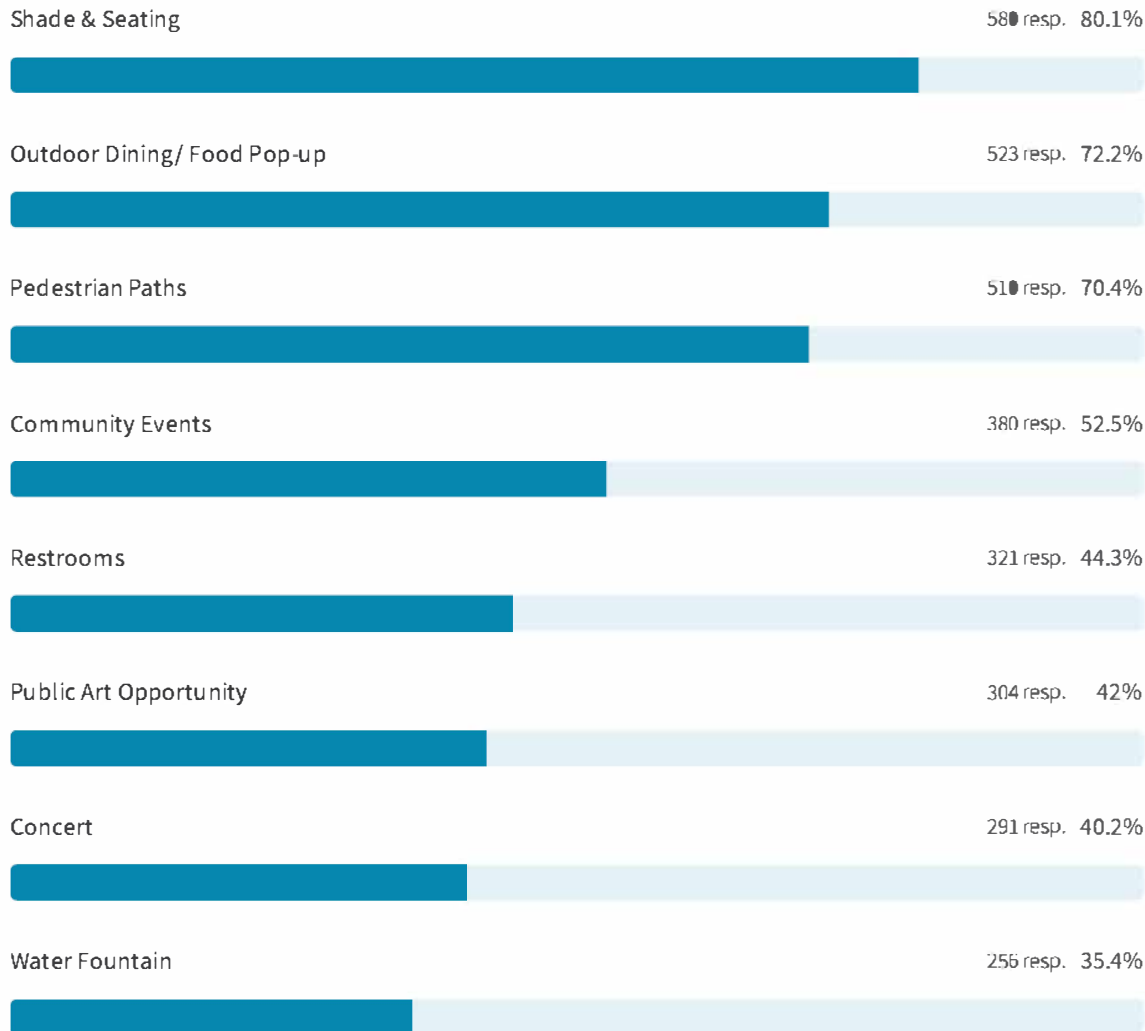

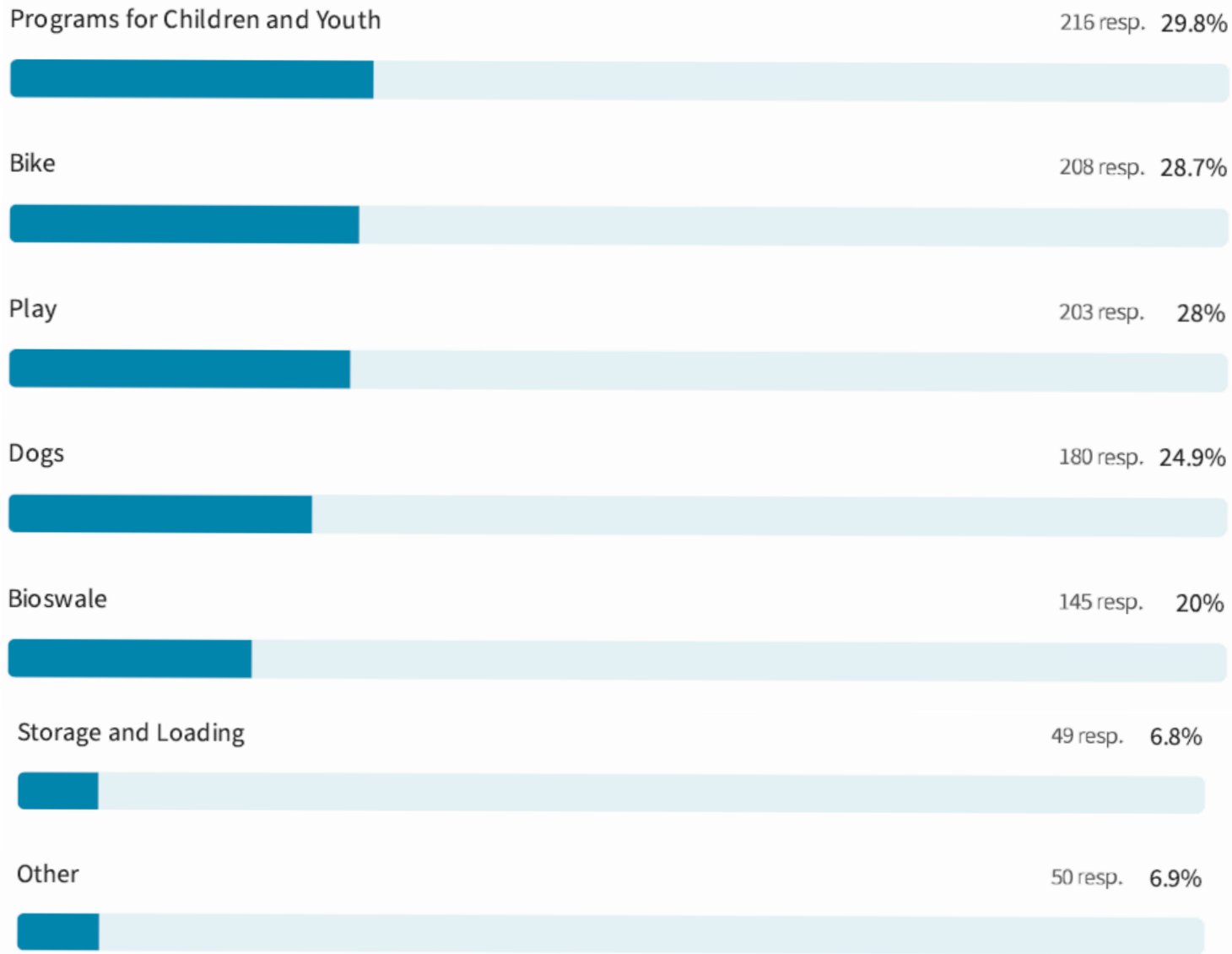

## **'Other' responses:**

1. Sidewalks with planter beds are perfect.
2. More trees
3. Night club
4. I do not favor this idea.
5. No ugly orange barricades
6. More parking, we lost some, added some back then took some away again while growing / attracting more people to visit.
7. Outdoor dining, more shopping
8. Covid is over. Look at all the places that left. Keep it a street
9. Keep the street open to traffic and parking
10. Biergarten
11. I do not support the closing of streets
12. Don't change it, there isn't enough parking as it is!
13. None of the above. Keep it open with no parklets and plenty of parking
14. More parking!
15. No parking on the 600 block of laurel
16. Zero waste collection bins
17. Leave it open to cars, no closure
18. Do not close street to cars
19. Wifi
20. Parking - fruit trees - more police
21. Better lighting/security at wheeler plaza garage at night. I don't feel safe parking there
22. Water fountain that features water bottle refill and dog water fountain
23. Don't close, open to vehicles, with parking
24. Retail retail retail
25. How big does city staff have to grow to take care of the new trees? Will prop-erty owners be responsible for their care?
26. Housing, nature
27. Get rid of this silly pedestrian idea. It doesn't work and breaks up the down-town. I avoid this block!
28. No gentrification
29. None! You are taking parking away and closing the street just creates a space for teenagers to hangout. It doesn't bring people in to shop locally at all Vehicle access

## Question 10

10 → Which of these street right-of-way configuration ideas related to sidewalk expansion, street greening, outdoor seating, parking, etc. on 600 and/or 800 block of Laurel Street would best achieve the vision for a vibrant and active downtown?

Concept 1 / Concept 2 / other ideas?

Type your answer here...

## 600 & 800 BLOCKS ON LAUREL ST

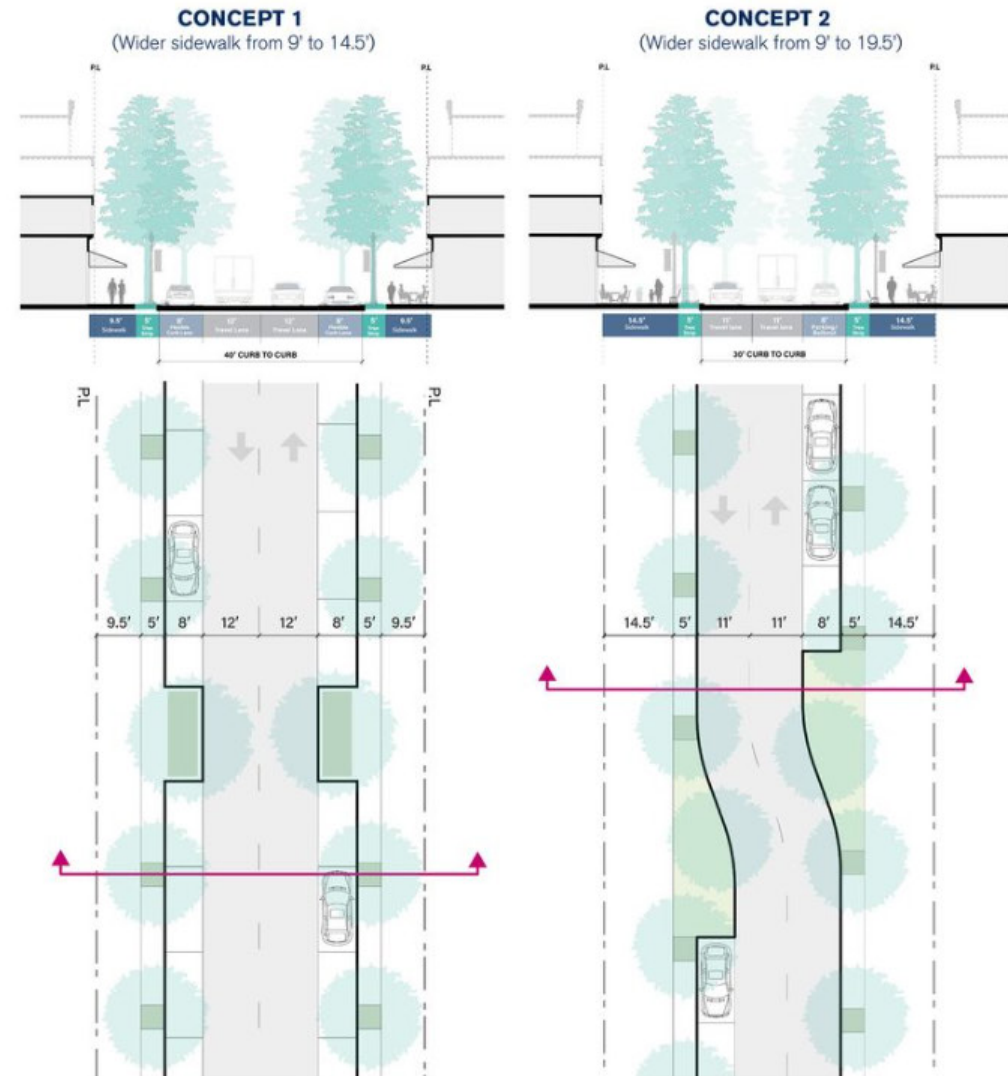

## Responses

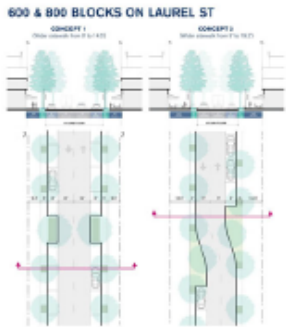

Which of these street right-of-way configuration ideas related to sidewalk expansion, street greening, outdoor seating, parking, etc. on 600 and/or 800 block of Laurel Street would best achieve the vision for a vibrant and active downtown?

**Concept 1:** Approximately 40% of responders preferred Concept 1

**Concept 2:** Approximately 60% of responders preferred Concept 2

### 'Other' responses:

1. Decrease the number of parking spots along the side? Will having parking options on the street make through traffic very difficult with people pulling in and out and waiting for spots?
2. Minimize parking, maximize the space for people.
3. Keep it the way it is.
4. None
5. Lot's of trees and bushes.
6. Do not change anything, it works as is.
7. Pedestrian walkway only

## Question 11

11 → Consider proposed changes to **San Carlos Avenue** in the diagrams below.

Which ideas related to sidewalk expansion, street greening, bike infrastructure, outdoor seating, road diet, parking, etc. do you think would make San Carlos Avenue function better as a gateway to the downtown?

Type your answer here...

### SAN CARLOS AVENUE (LOOKING EAST)

EXISTING

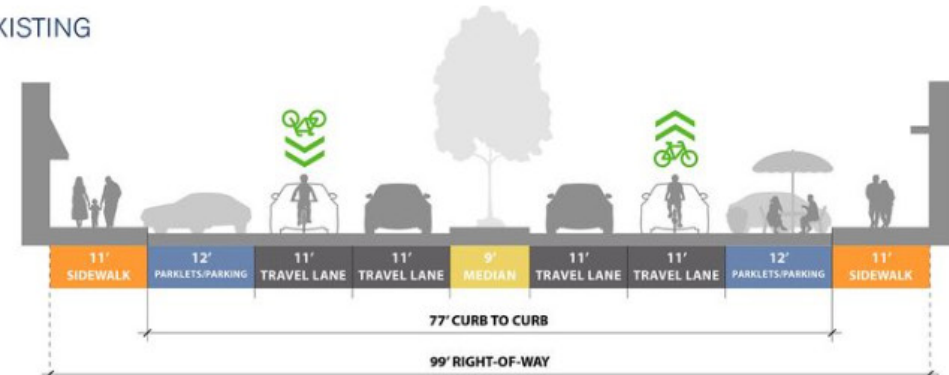

P.L.

P.L.

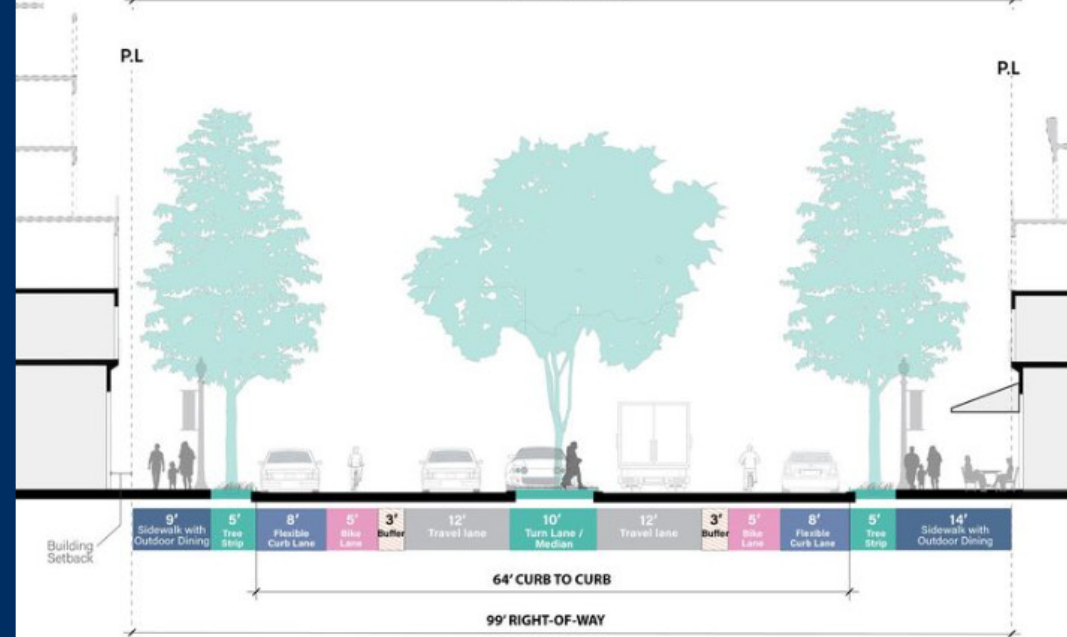

PROPOSED

## Responses

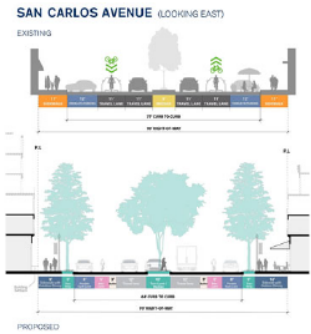

Consider proposed changes to **San Carlos Avenue** in the diagrams below.

### Recurring Themes:

- Parking availability and restrictions
- Traffic flow and road layout
- Street greening and tree planting
- Outdoor dining and seating areas
- Bike lanes and pedestrian spaces

1. 64' curb to curb
2. No!
3. Road diet. 4 Lanes of travel creates big natural barrier.
4. Any amount of increased street greening, outdoor seating/dining, more space for pedestrians and alleyway parking?), That would be ideal. Perhaps parking on the 2 blocks could be limited to 20-30 minutes only to support the businesses with a majority of spots for handicapped?
5. Parklets need to be more attractive from the street, look less like tent encampment. More street trees.
6. Sidewalks with dining
7. Street greening. More trees do not use car lane for bike lane
8. Existing- no way one car lane will be adequate
9. Outdoor seating, more greenery
10. Maximize space for people. Cars should be secondary
11. Neither, get rid of the auto-oriented center turn lane/ median and give that back to pedestrians and bikes. Alternatively, use the median for parking like w. Lancaster blvd in Lancaster, ca.
12. Difficult to see on a phone. Keep it the way it is.
13. Less cars, more trees, more square-shaped space for connecting with other people. Space for
14. Looks great! I love the addition of the bike lane to this street.
15. Dedicated bike lines.
16. There's only 1 choice here.
17. Restrooms
18. Do not change anything, it works as is.
19. Like proposed
20. The proposed changes appear to reduce san carlos ave to one lane of vehicle travel each way. This is a major artery traveling east toward el camino and should have two lanes traveling east. Since only one lane of traffic from el camino can turn onto san carlos at a time, perhaps only one travel lane is necessary westbound on san carlos ave from el camino, but two lanes (or one lane plus a dedicated left turn lane) should be available going west whenever a left turn is possible (so left turning traffic does not impede thru-traffic.)
25. Street greening, less street parking
26. More division between car lanes and outdoor eating areas.
27. Parklets, outdoor dining and parking
28. Turn lane options, for sure!
29. The more trees, greenway, and parks the better.
30. I like the proposed plan, with the separate bike lane and a wider sidewalk for outdoor dining.
31. Option 2
32. Given the access to the west side of sc leave existing
33. Outdoor seating and more trees
34. Proposed scheme subject to traffic study for lane reduction



## Question 12

12 → Consider proposed changes to **El Camino Real** shown in the diagrams below.

Which ideas related to sidewalk expansion, street greening, bike infrastructure, road diet, parking, etc. do you think would make El Camino Real function better as a bike and pedestrian-friendly Complete Street and a gateway to downtown San Carlos?

Type your answer here...

### EL CAMINO REAL (LOOKING NORTH)

EXISTING

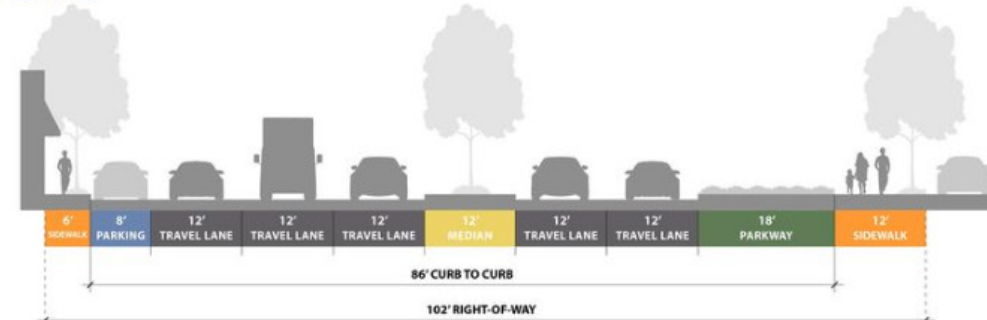

P.L.

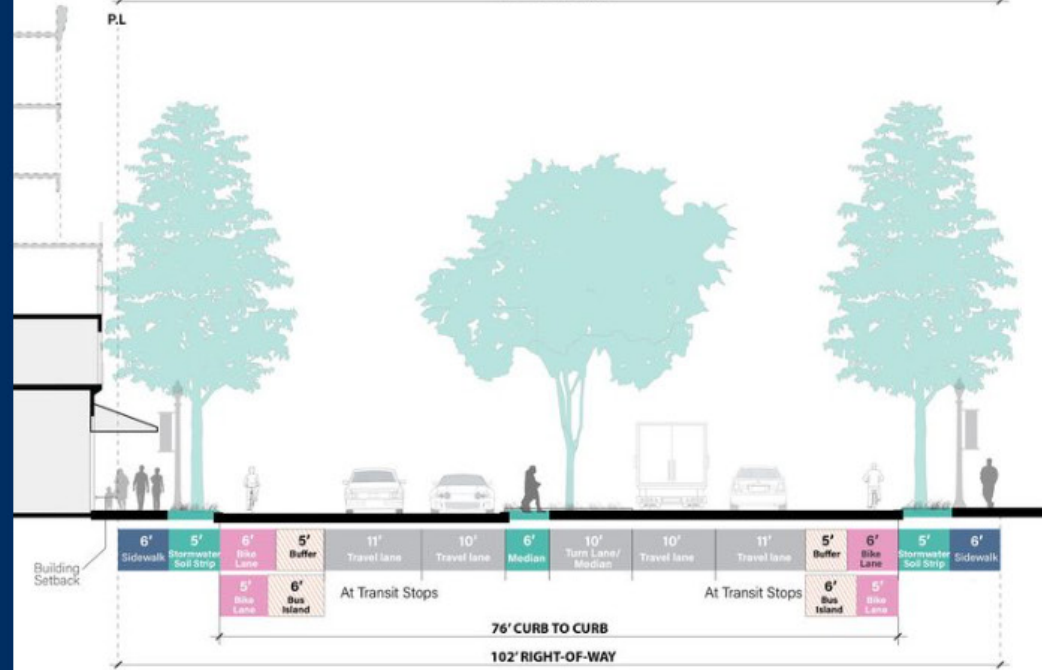

PROPOSED

## Responses

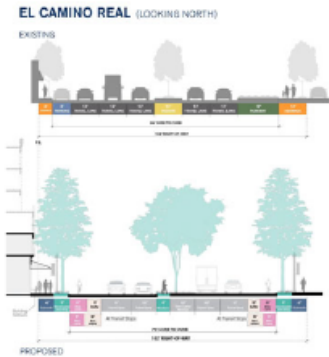

Consider proposed changes to **El Camino Real** shown in the diagrams below.

### Recurring Themes:

- Parking concerns
  - Road and traffic management
  - Pedestrian and cyclist safety
  - Street greening and beautification
  - Preservation of existing layout and features
1. Proposed is better
  2. 76 curb To curb
  3. No!
  4. Road diet southbound. Wider sidewalks.
  5. It seems ideal to shrink ecr down to 2 travel lanes for a short distance around the downtown of sc. Wondering if it will just make an already crowded travel route more of a road rage? Is there a way to buffer the town from ecr by “thicker” buffering? I like the idea of no parking along ecr for a specified range and increasing the safety of the parking on the east side of ecr.
  6. More street trees on both sides and in center median. Parking is needed.
  7. Why are trees bigger in the proposed visions? Lol. More trees every-where, please.
  8. Safer (wider?) Pedestrian walk zone from caltrain
  9. More walkability would be great
  11. Existing
  12. Strongly prefer proposed scheme with fewer travel lanes and larger trees to better coordinate with traffic lanes in belmont and redwood city
  13. No comment as i am not clear from the diagrams.
  14. Medians, fewer traffic lanes. Greening
  15. Way more space for trees so they can grow large and healthy to help with scale, parking buffered bike lanes, skinny median like wilshire blvd in santa monica, less travel lanes to induce congestion and slow traffic for increased pedestrian and bike safety.
  16. Difficult to see on a phone. Keep it the way it is.
  17. I like laurel to be hidden from el camino traffic
  18. Great!
  19. Sidewalk pedestrian access
  20. Dedicated bike lines would be preferred.
  21. There's only one idea here.
  22. Street greening
  23. Available parking
  24. The proposal pictured here is not detailed enough to make an educated decision because el camino at san carlos ave and el camino one block away at holly are very different due to holly being the main artery in/out of downtown.

## Question 13

13 → Consider proposed changes to **Arroyo and Brittan Avenues** shown in the diagrams.

Do you like these street and sidewalk configuration ideas to make Arroyo and Brittan a bicycle boulevard? Please share other ideas you may have.

Type your answer here...

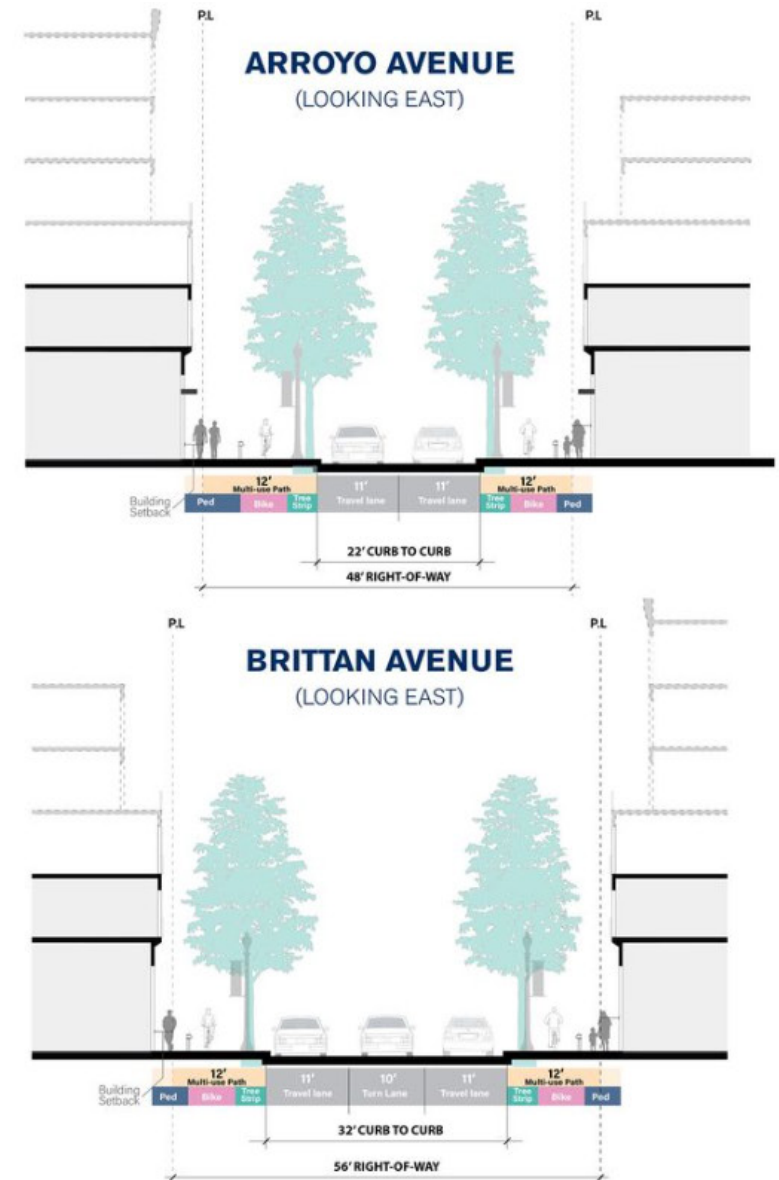

## Responses

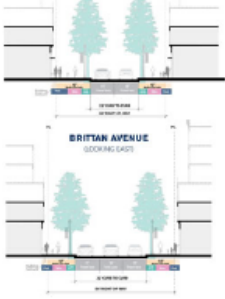

Consider proposed changes to **Arroyo and Brittan Avenues** shown in the diagrams.

### Recurring Themes:

- Bike and Pedestrian Infrastructure and Safety
  - Preservation of Vehicular Traffic Flow and Access
  - Environmental Enhancements and Tree Planting
  - Support for Multi-use Paths and Walkability
  - Concerns Over Parking Availability and Management
1. 2 lane
  2. Stop messing with my town!
  3. Wide multi-use path looks great.
  4. I would support the changes to Arroyo over the Brittan Ave changes since Britain is more of a major thoroughfare than Arroyo. For access to Britain Park, Arroyo can be used and the park accessed by better bike and pedestrian safety along Cedar Street & Elm Street.
  5. More trees and consideration for bicycles
  6. New
  7. Seems ok
  8. Left turn lanes
  9. Yes
  10. You'll never get away with 22' curb to curb because of the fire department wanting 13' lanes for their huge trucks and outriggers. 12' with trees, building entries and street furnishings (lights, transform-ers, utility cabinets, etc.) isn't enough space
  11. A bike boulevard is a great idea.
  12. Like it!
  13. No Speed deterrents on Holly
  14. Make the entire downtown more pedestrian friendly. Promote walking around the downtown area. Less reliant on cars.
  15. Ped and bike lanes need to be separated
  16. Having bicycle boulevards would be a plus
  17. I like the idea of adding bike lanes but would this mean no one can park on the street? We still need places to park.
  18. Traffic mitigation, traffic lights to safeguard pedestrians
  19. 22 ft curb to curb

20. Do not change anything, it works as is.
21. Proposed
22. Existing
23. As with El Camino near Holly/San Carlos Ave, Brittan Ave is the other major artery in/out of downtown, so I think care should be taken to allow for current or future increased vehicular traffic volume (since population/housing is expected to increase, vehicular traffic likely to increase). Therefore, I think it makes sense to add the pedestrian/bike/multi-use path along Arroyo, but not Brittan if the changes to Brittan would restrict vehicular traffic flow.
24. existing is fine
25. Trees dividing travel and multi-use lane is good. Bushes or large planters could also be nice. Trees in an oversized elevated planter could be nice too. Would give more weight and substance to the division between travel lanes and multi-use lane. Separating bike lane from walking lane with bollards is also great. Would probably need some sidewalk markings to make sure which side is pedestrian vs wheeled. The bollard is especially important if allowing e-scooters or e-bikes in multi-use lane. Would need to establish guidelines as to whether motorized non-car wheeled transportation is allowed or just human powered bikes, skateboards, or push scooters
26. Wider sidewalk
27. Looks good
28. no
29. Yes
30. More walkability would be great
31. Yes
32. No, make quieter side streets into bike blvds
33. The bike lanes with physical separation are welcome. Could one bike lane with bikes in both directions work?

## Question 14

14 →

Please select the images that resonate with your vision for downtown San Carlos.

*Description (optional)*

Choose as many as you like

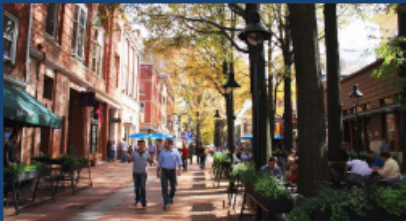

A



B



G



H



C



D



I



J



E



F

# Responses

Please select the images that resonate with your vision for downtown San Carlos.

724 out of 761 answered

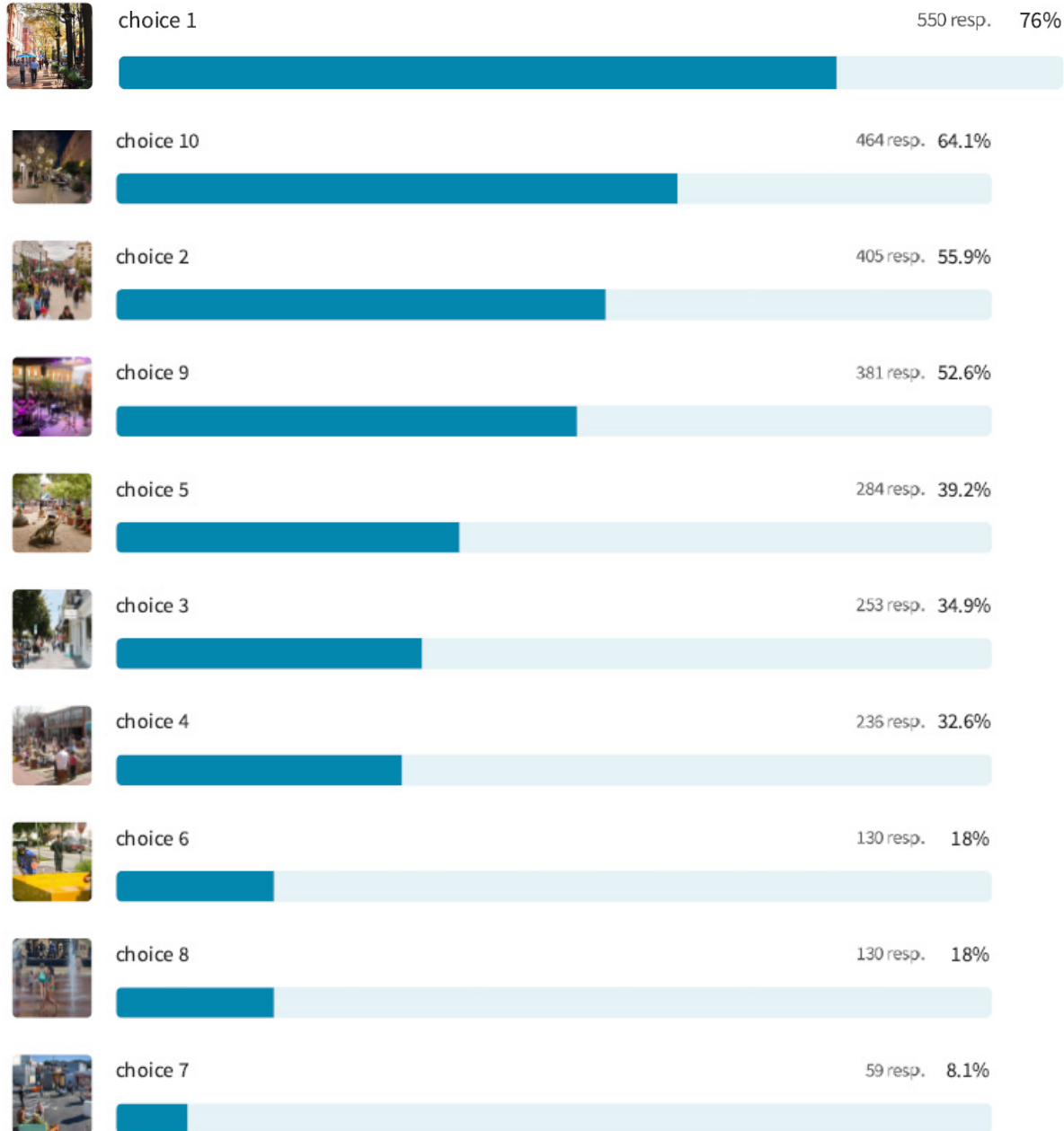

If you would like to share other ideas about your vision for the downtown, please share them here!

305 out of 761 answered

## Recurring Themes :

- Pedestrian-friendly and safe walking areas
- Preservation and enhancement of greenery (more trees and parks)
- Community-oriented spaces (including a community pool and places for all ages)
- Traffic and parking management
- Maintaining the small-town vibe and character Inclusive planning for all ages and abilities
- Outdoor dining and cafe culture
- Infrastructure improvements (lighting, street furniture)
- Art and culture (activating alleys, avoiding big events that could be disruptive)
- Enforcing existing traffic and vehicle laws

1. Let's make San Carlos a forested city! With native trees like oaks, redwoods, madrones, manzanita much nicer hanging flower baskets.
2. Please find a place for a community pool! This is what our town desperately needs.
3. Seems like the team is missing an opportunity to better link the Caltrain station to downtown.
4. Please talk to the business owners. Laurel Street (700 block) has a different 'vibe' throughout day.
5. Thank you for your work.
6. Thank you for all of the time spent on this project. Beautiful ideas!
7. Reduce speeds on holly.
8. Make it really pedestrian friendly. Promote walking around town.
9. Sticky saps from the trees need to be addressed. The current diseased tree makes pavement sticky.
10. Laurel Street is definitely the heart of San Carlos. Many towns do not have space like this.
11. Quit ruining everything. Keep things the same.
12. I like the idea of more European pedestrian area. Limit kid focused on laurel.
13. Besides downtown: safe walking streets on Brittan W of Alameda are needed.
14. I'm thinking you would be well to find out what other cities have done and visit them for ideas.
15. Cobblestones section with illuminated tiles with inspirational wording like Place du Molard in Geneva, CH.
16. Improve design standards and reduce the length of parklets. Outdoor eating, not covered shacks.
17. The downtown should primarily provide for the daily needs of the community.
18. Consider ample and attractive street lamps consistent from 600-800.
19. No further comments.
20. Please consider all ages/stages. Thank you!
21. All things pedestrian friendly please! No need to cater to our car culture.



22. Activate the alleys so they specialize in art or antiques and change delivery to 2:00 AM.
23. More trees, the better.
24. Great vision, thank you! Arroyo Ave should connect to cedar street, which needs protected bike lanes.
25. Please no concerts or big events that trash our beautiful city.
26. Those huge orange dividers are awful.
27. It would be great to have multiple places for people of all ages/abilities could go and "hang out".
28. Night club.
29. Lived in SC for years and miss the small town vibe. Nostalgic for independent stores, shops, and res.
30. Please consider an ordinance restricting overnight parking in San Carlos like Menlo Park.
31. I don't care for street closures. For bike lanes, strict enforcement of vehicle laws.
32. Worldwide downtown areas are designed for people. Outside dining, young adults, people. Interfacing.
33. Thank you for asking!
34. More kid-friendly mini playgrounds.
35. All restaurant owners should pay market rate for expanded outdoor seating.
36. Close Laurel to traffic, increase service shopping for locals.
37. It's not a shopping mall. It should look and act like a walkable treed urban space.
38. I would like to see cafe seating on the main walkway and enjoy people watching.
39. Shuttle to eliminate traffic/parking for those that do not live within walking distance, and seniors.
40. Whatever is done downtown, please enforce the traffic laws better than they are enforced at this ti.
41. I loved how the vision statement made accessibility such a prominent point.
42. San Carlos is a family town, keep it welcoming for all ages! Plants, trees, and more seating.
43. If a water feature is installed make sure it uses a water pump that doesn't drain and waste water.
44. The magic of San Carlos is the community. Optimize downtown for regular community events.
45. Let's also make this a place where the youth feels welcome 12-18.